

PROPOSED G+III STORIED RESIDENTIAL BUILDING, OF 12.475M. HEIGHT, AT PREMISES NO. 17, PANDITIA PLACE, U/S 393A OF K.M.C. ACT 1980 AND UNDER K.M.C. BUILDING RULES 2009, POLICE STATION - RABINDRA SAROBOR (FORMERLY LAKE), WARD NO. - 085, BOROUGH NO. - VIII, KOLKATA-700 029, UNDER KOLKATA MUNICIPAL CORPORATION.

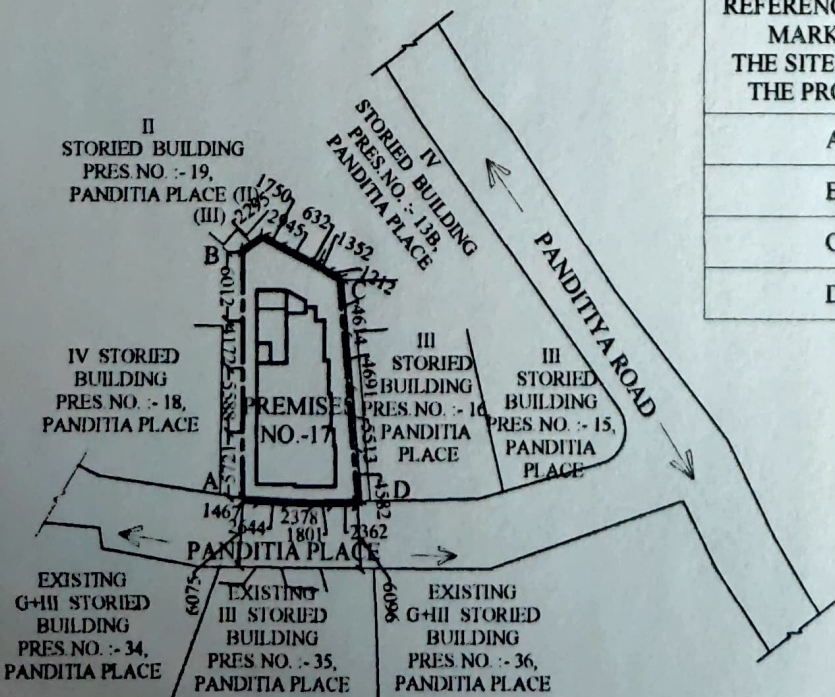
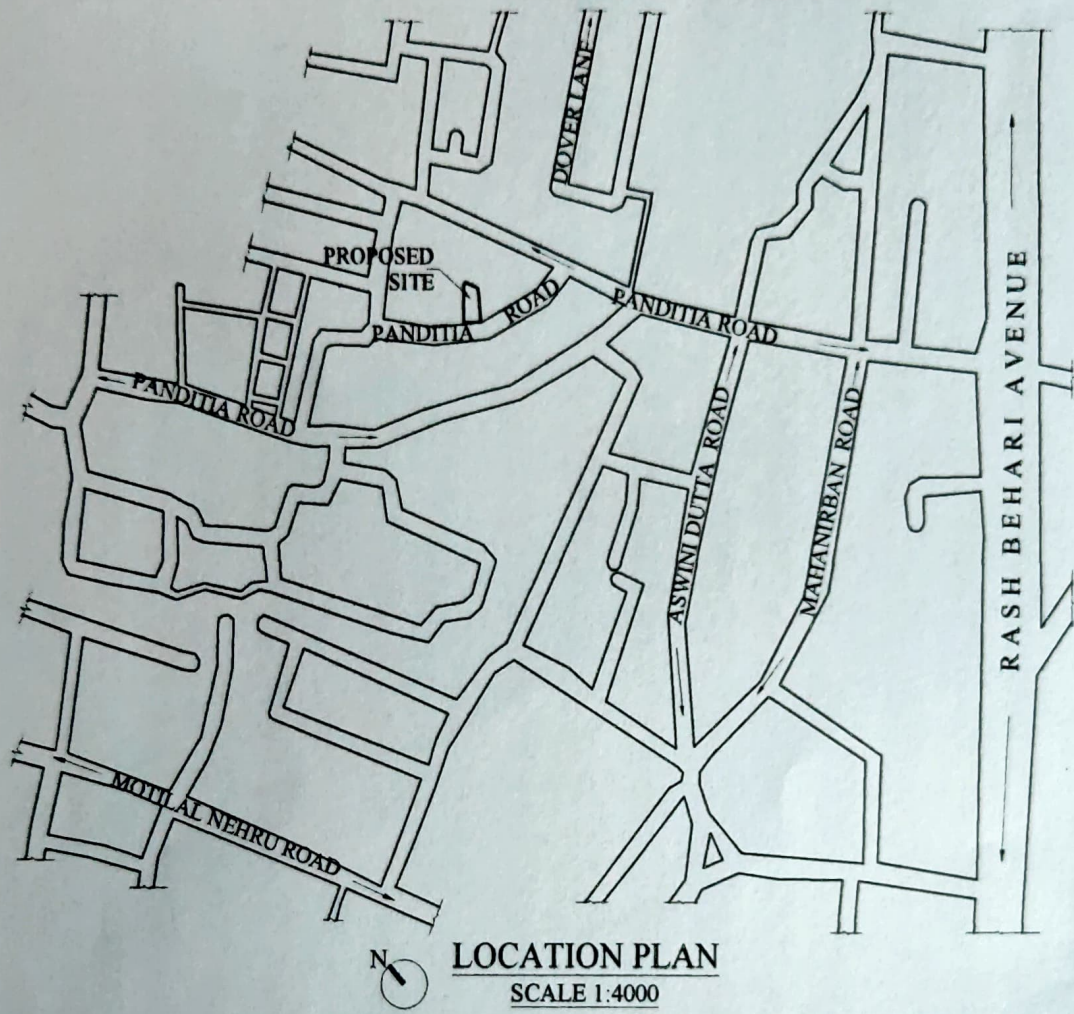

REFERENCE POINTS MARKED IN THE SITE PLAN OF THE PROPOSAL	CO-ORDINATE IN "WGS84"	
	LATITUDE	LONGITUDE
A	N 22° 31' 17"	E 88° 21' 29"
B	N 22° 31' 17"	E 88° 21' 30"
C	N 22° 31' 17"	E 88° 21' 29"
D	N 22° 31' 17"	E 88° 21' 29"

ADITYA GOSWAMI, M, Arch.
Regd. No. CA/2004/33103
Registered with the Council
of Architecture, India

Aditya Goswami

ADITYA GOSWAMI M.Arch.
Regd. no. CA/2004/33103
Registered with the Council of
Architecture, India.

SIGNATURE OF ARCHITECT